



WATERPROOFING

COLPHENE[®] 3000 FOUNDATIONS



SELF-ADHESIVE WATERPROOFING MEMBRANE FOR FOUNDATIONS

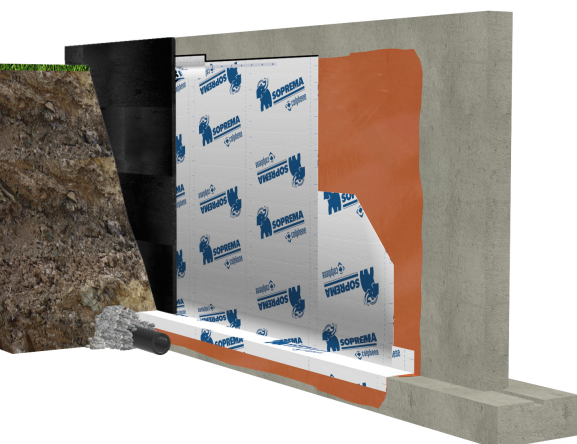

COLPHENE 3000 self-adhesive membrane is made from the most reliable SBS modified bitumen in the industry and has a tri-laminated woven polyethylene facer. It is extremely flexible, easy to handle, and fits easily around the sharp contours and angles of concrete footings and foundations. COLPHENE 3000 is the perfect solution for below grade and retaining wall waterproofing.

- Superior flexibility
- Cold applied, flameless solution
- Puncture resistant with high tensile strength
- Consistent thickness

SURFACE PREPARATION

COLPHENE 3000 must always be installed on clean, dry, solid substrates, which have been primed before application with ELASTOCOL STICK or ELASTOCOL STICK H₂O.

COMPLEMENTARY PRODUCTS

ELASTOCOL STICK & ELASTOCOL STICK H2O

Used to prepare surfaces before the installation of self-adhesive membranes.

SOPRAMASTIC / SOPRAMASTIC ALU

Ideal complement to bituminous waterproofing membranes as joint filler and caulking material.

SOPRADRAIN 10 & SOPRADRAIN ECO 10

Promotes better flow towards drains, while reducing hydrostatic pressure.

COLPHENE 3000	
THICKNESS	1.5 mm
ROLL DIMENSIONS	1m x 18.7m
SURFACE	Tri-laminated woven polyethylene
UNDERFACE	Silicone release film



INFO@SOPREMA.COM.AU



SOPREMA.COM.AU

INSTALLATION INSTRUCTIONS

1



Prime the substrate with ELASTOCOL STICK or ELASTOCOL STICK H₂O.

2



Install a reinforcement strip membrane centered on the corner of all interior and exterior foundation angles.

3



Peel back the top part of the silicone release film. Adhere COLPHENE 3000 to the substrate, making sure the membrane is well aligned.

4



Gradually peel back the remaining silicone release film, making sure the membrane is completely adhered.
The use of a hand roller is required to remove air pockets.

5



Use SOPRAMASTIC / SOPRAMASTIC ALU to seal details and critical areas.
The use of a protection or drainage board is recommended before backfilling to ensure the integrity of the waterproofing membrane.

6



Use a pressure seal termination bar with a bead of SOPRAMASTIC / SOPRAMASTIC ALU to seal the membrane termination

If you have any questions about this product or its installation, please contact your SOPREMA representative.